

Application Review

Application Details

Application Number: 1046592 Application Date: 21/11/2025
Current Status: Approved Application Type: New Consent
Amount Due: £361.00 Original Consent Number: Not Applicable
Payment Id: [REDACTED] Final Consent Number:
[REDACTED]
File Number: NC2209/25_1

Payment Details

Amount Paid £361.00 Payment Date: 11/24/2025 16:51:53

Agent Details

Agent Name: [REDACTED]
Agent Address: [REDACTED]
[REDACTED]
[REDACTED]
[REDACTED]
[REDACTED]
[REDACTED]
Telephone: [REDACTED]
Email: [REDACTED]

Applicant Details

Applicant Name: [REDACTED]
Applicant Address [REDACTED]
[REDACTED]
[REDACTED]
[REDACTED]
[REDACTED]
[REDACTED]
Telephone: [REDACTED]
Email: [REDACTED]

Site Details

Site Address: [REDACTED]
[REDACTED]
[REDACTED]
[REDACTED]
[REDACTED]

Easting: 235803

Northing: 341394

Discharge Details

Is the consent type a Waterway or Soakaway/Underground Waterway
Stratum:

Is the discharge proposed or existing: Proposed

Is there an NI Water Ltd foul sewer/private sewer within 20 metres available? No

Is there more than one house on the development: No

Do you have a planning application reference number? No

Proposed Waterway

Will a tertiary treatment (e.g. reedbed) be provided? No

Type of treatment system proposed? Tricel vitar uk6

Is the system certified to BS 12566-3 Yes

Treatment efficiency (if known) % BOD removal 98.1

Documents

<u>Document Type</u>	<u>Name</u>	<u>Date Uploaded</u>
Location Map	[REDACTED] map.pdf	21/11/2025
Site Plan	[REDACTED] plan.pdf	21/11/2025
CE Certification	Cert Tricel -Vitae 98%.pdf	21/11/2025



Prüfinstitut für
Abwassertechnik
GmbH

PERFORMANCE RESULTS

Tricel (Killarney)

Ballyspillane Industrial Estate, Killarney, Co. Kerry, Ireland

EN 12566-3

Results corresponding to the Irish National Annex for IS EN 12566-3

Small wastewater treatment system Tricel Vitae

Sequencing Batch Reactor Vitae in combination with REWATEC GmbH
(see REWATEC GmbH SOLIDO® certificate)

Nominal organic daily load*	0.25	kg/d		
Nominal hydraulic daily load	0.75	m³/d		
Material	Glas reinforced plastics			
Watertightness (water test)	pass			
Crushing resistance (calculation method)	pass (also wet conditions)			
Durability	pass			
Treatment efficiency (nominal sequences)		Efficiency		Effluent
	COD	94.3 %		37.3 mg/l
	BOD ₅	98.1 %		6.1 mg/l
	NH ₄ -N	94.2 %		2.9 mg/l
	SS	96.2 %		13.8 mg/l
Electrical consumption	0.65	kWh/d		

*at a test influent of ≥ 300 mg/l BOD₅ (mean)

Performance tested by:

PIA – Prüfinstitut für Abwassertechnik GmbH

(PIA GmbH)

Hergenerather Weg 30

52074 Aachen, Germany

This document replaces neither the declaration of conformity nor the CE marking.



Notified Body
Nr.: 1739



Certified according to
ISO 9001:2008



Deutsche
Akkreditierungsstelle
D-PL-17712-01-00

Prüfinstitut für Abwassertechnik GmbH

geprüft - tested - testé

Elmar Lancé

March 2014

Our Ref: NC 2209/25

[REDACTED]
[REDACTED]
[REDACTED]
[REDACTED]

NIEA Water Regulation
17 Antrim Road
Lisburn
Tonagh
BT28 3AL
Telephone: 028 92 623181
Email: domesticconsentsqueries@daera-ni.gov.uk

Date: 23 March 2026

Dear [REDACTED],

WATER (NORTHERN IRELAND) ORDER 1999 – RE NC 2209/25

I refer to the application which you submitted, on behalf of your client [REDACTED], for consent to discharge sewage effluent from premises at [REDACTED], [REDACTED]

The Water Quality Inspector processing the application has requested additional information detailed in the attached pro-forma.

Accordingly, it is not possible to progress this application any further.

This letter should be taken as notification that this application is now suspended and will only be reinstated if the information requested is received.

Failure to supply the requested information within 84 days from date of this letter will result in the refusal of your application. A new application will then need to be submitted, and appropriate fee will be required.

Under the terms of the Water (Northern Ireland) Order 1999, all effluent or sewage discharges which are not connected to the public sewer, require the consent of the Department. Therefore a consent must be obtained as it is an offence under the Water (Northern Ireland) Order 1999 to discharge any effluent into a waterway (or water contained in underground stratum), without the consent of the Department of the Environment for Northern Ireland, the penalty for which on summary conviction is imprisonment for a term not exceeding 3 months, or a fine not exceeding £20,000, or both.

The additional information should be emailed to domesticconsentsqueries@daera-ni.gov.uk quoting the above reference number.

Sustainability at the heart of a living, working, active landscape valued by everyone.



Yours sincerely,

[Redacted]

[Redacted]

[Redacted] Regulation

Sustainability at the heart of a living, working, active landscape valued by everyone.



An Agency within the Department of
**Agriculture, Environment
and Rural Affairs**
www.daera-ni.gov.uk

Gníomhaireacht de chuid na Roinne
**Talmhaíochta, Comhshaoil
agus Gnóthaí Tuaithe**

An Agency wí'n the Depairtment o
**Fairmin, Environment
an' Kintra Matthers**

INVESTORS IN PEOPLE
We invest in people Standard

Application reference number: NC2209/25_1	Date 23/03/2026
Applicants name: [REDACTED] Site address: [REDACTED]	
Water Quality Inspector: [REDACTED] Direct phone number: [REDACTED]	

Who was contacted?

Applicant	x <input type="checkbox"/>	Agent	<input type="checkbox"/>	Neither	<input type="checkbox"/>
Date of contact: 02/03/04/18 Feb '26 12/03/26			Date of site visit: 17/12/2025, 19/03/26		
Reason for suspension: [REDACTED] is seeking legal advice regarding access to the existing sewage treatment system and legal easement for the site.					

Amendments required:

Application form-Full	<input type="checkbox"/>	Amended page 3	<input type="checkbox"/>
CE certificate	<input type="checkbox"/>	% BOD required	<input type="checkbox"/>
Location map (2 copies)	<input type="checkbox"/>	Site plans (2 copies)	<input type="checkbox"/>

Map/plan to show changes to:

Discharge point to w/way	<input type="checkbox"/>	Position of septic tank	<input type="checkbox"/>
Extent of land owned/controlled by applicant	<input type="checkbox"/>	Position of soakaway	<input type="checkbox"/>
		Position of package plant	<input type="checkbox"/>

Other information/applicant options:

COPYRIGHT STATEMENT
Except as otherwise permitted under the Copyright Designs and Patents Act 1988 this map may only be reproduced, stored or transmitted in any form or by any means, with the permission of Land & Property Services.

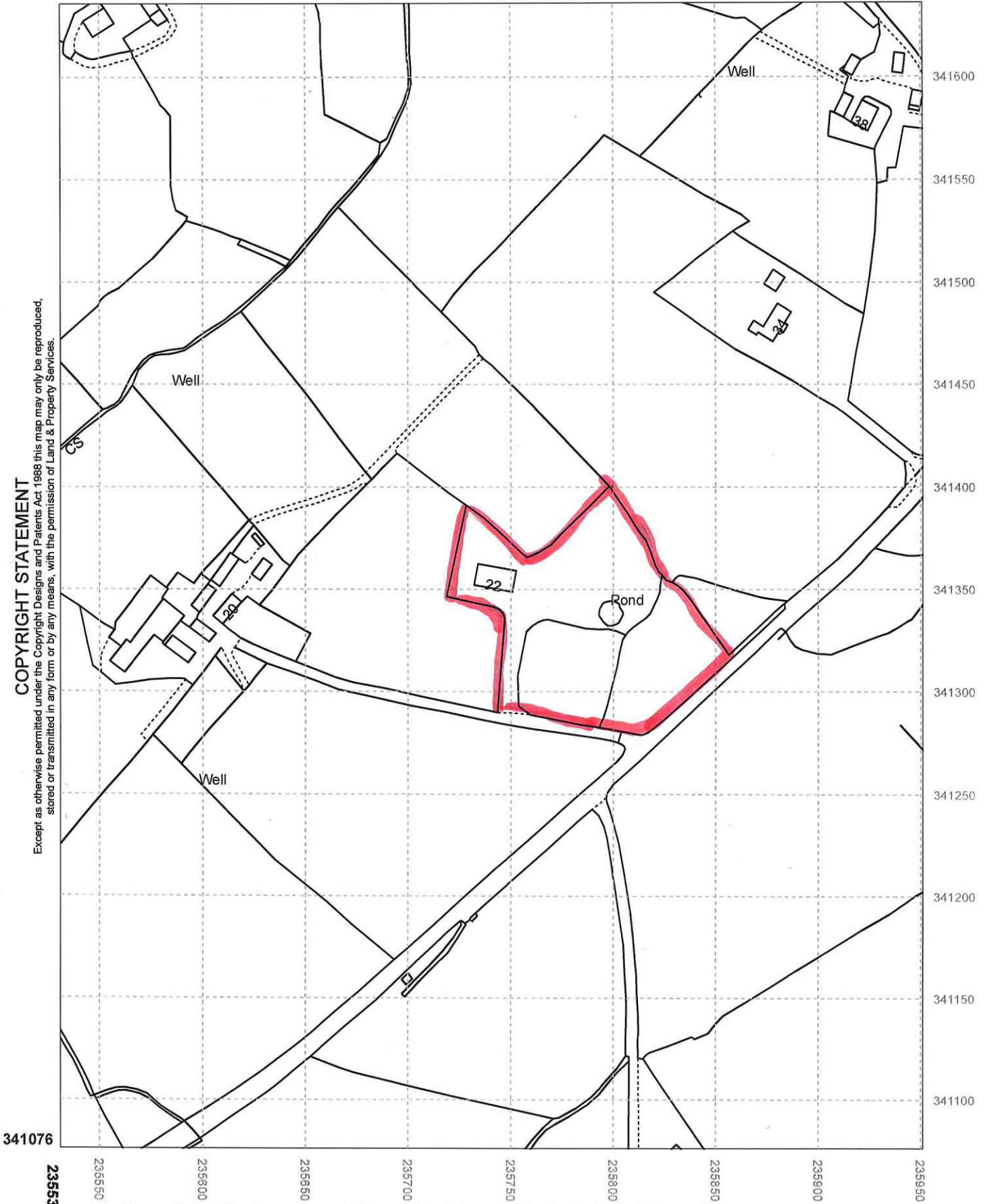

Every care has been taken to ensure accuracy in the compilation of this map at the time of publication. Land & Property Services cannot, however, accept responsibility for errors or omissions and when such are brought to our attention, the amendment of any future publication as appropriate shall be entirely at our discretion. Ordnance Survey of Northern Ireland and ACEmap® are registered Trademarks of Department of Finance and Personnel.

Copyright Statement
Except as otherwise permitted in any form or by any means, with the permission of Land & Property Services.

