

Proposed North Boatyard Seawall Repair Works - Plan [1:200]

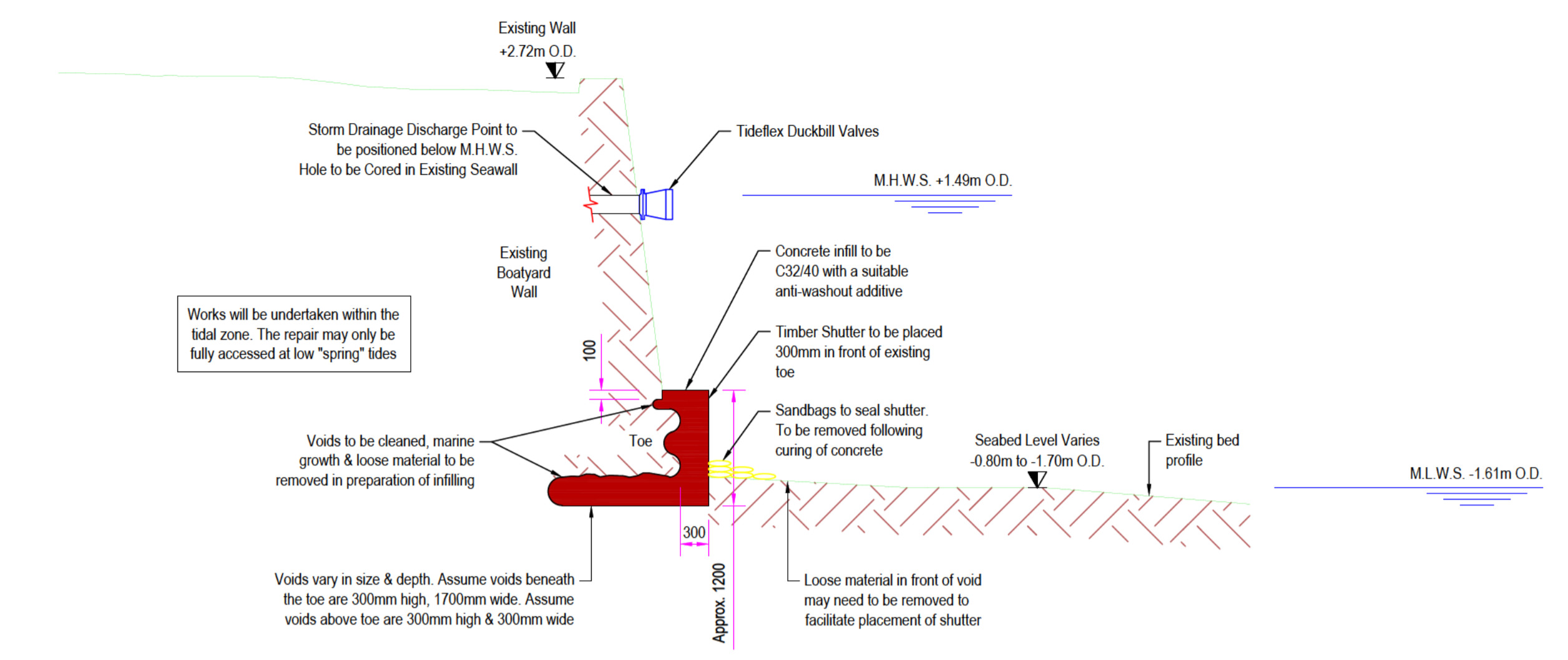

Section A-A - Seawall Toe Repair Detail [1:50]

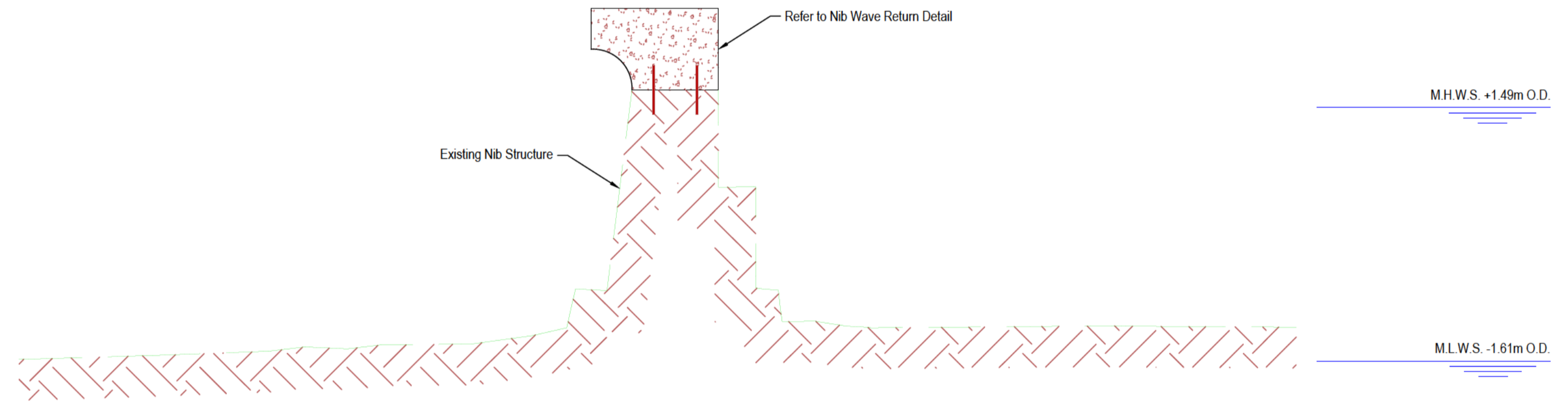

Section B-B [1:50]

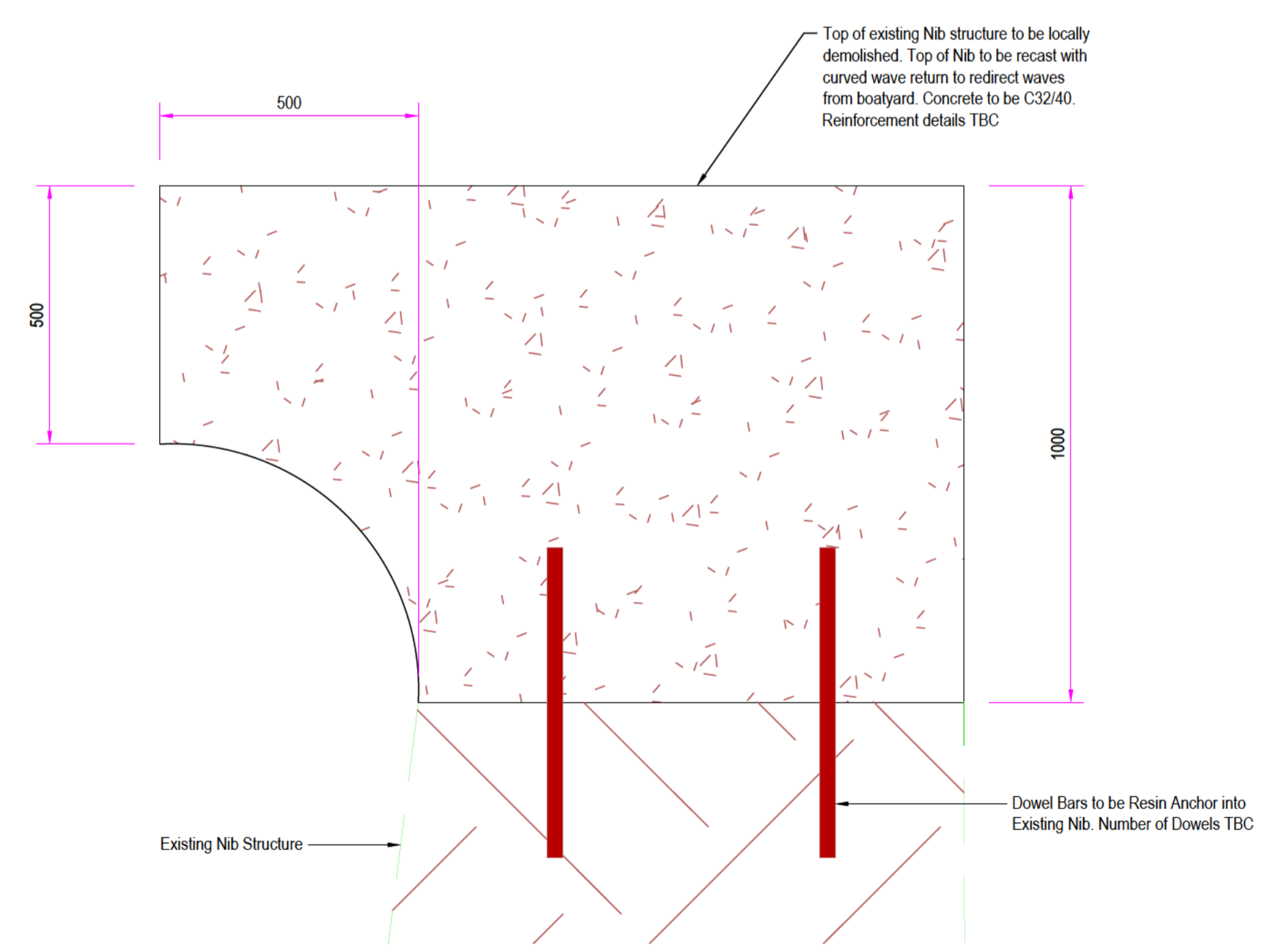

Nib Wave Return Detail [1:10]

- NOTES**
1. Verifying Dimensions.  
The contractor shall verify dimensions against such other drawings or site conditions as pertain to this part of the work.
  2. Existing Services.  
Any information concerning the location of existing services indicated on this drawing is intended for general guidance only. It shall be the responsibility of the contractor to determine and verify the exact horizontal and vertical alignment of all cables, pipes, etc. (both underground and overhead) before work commences.
  3. Issue of Drawings.  
Hard copies, dwf and pdf will form a controlled issue of the drawing. All other formats (dwg, dxf etc.) are deemed to be an uncontrolled issue and any work carried out based on these files is at the recipient's own risk. RPS will not accept any responsibility for any errors arising from the use of these files, either by human error by the recipient, listing of un-dimensioned measurements, compatibility issues with the recipient's software, and any errors arising when these files are used to aid the recipient's drawing production, or setting out on site.
  4. Datum. Ordnance Datum (unless noted otherwise)
  5. Key  
    - Seawall Toe Repair (see Section A-A)
    - Seawall Nib Return (see Section B-B)

C02	Issued for Marine License Application	P.M.	12/05/2026
C01	Issued for Marine License Application	P.M.	13/04/2025

rev	amendments	check	date
-----	------------	-------	------

**TETRA TECH**  
A TETRA TECH COMPANY

Elmwood House  
74 Boucher Road  
Belfast  
BT12 6RZ

**RPS**  
A TETRA TECH COMPANY

T +44 (0) 28 90 667914  
F +44 (0) 28 90 668286  
W [www.rpsgroup.com/ireland](http://www.rpsgroup.com/ireland)  
E [ireland@rps-tetratech.com](mailto:ireland@rps-tetratech.com)

Client  
**Ards and North Down Borough Council**

Project  
**Ballyholme Yacht Club**

Title  
**North Boat Yard Seawall Works**

Project Number POR-0884	Sheet Size A1	Drawing Scale As Shown
----------------------------	------------------	---------------------------

Drawing Number  
**POR00884-RPS-ML-ZZ-DR-C-0226**

Drawn By █	Status A1	Revision C02
---------------	--------------	-----------------

Checked By █	Approved By █	Date 07/07/2025
-----------------	------------------	--------------------